



# DOMINATOR™ EASYROLLER 14

SUITABLE FOR USE ON ROLLING SHEET DOORS

## YOUR 'GO TO' ROLLING DOOR OPENER

Our flagship rolling door opener, the Dominator EasyRoller 14™ features a slim profile, reliability, security and convenience. The slim-fit chassis suits low side room installations.

The Dominator EasyRoller 14™ incorporates bright LED courtesy lighting. The opener comes with Soft Start/Soft Stop operation, advanced door profiling and obstruction sensing for secure and safe operation. The Service Indicator lets you know when it is time to service your door. EasyRoller 14™ is suitable for use on doors up to 14ft.

## WHAT'S INCLUDED:



Opener with LED Courtesy Light



Wireless wall button and Two TrioCode™ 128 Remote Controls



Adaptors for multiple sheet door drum types



Safety Beams

## AT A GLANCE:

### SECURE & RELIABLE TRANSMITTERS

The TrioCode™ 128 remote control ensures secure and reliable home access. It transmits on three frequencies to defeat radio interference, and uses a 128-bit encryption protocol (with trillions upon trillions of random codes\*) for the ultimate in security.



\*340,282,366,920,938,463,463,374,607,431,768,211,456 codes

### KEY FEATURES

- 600N DC Motor
- Soft Start / Soft Close
- Slim fit design
- LED Courtesy Light
- Intelligent Safety System

### ADAPTORS AVAILABLE TO SUIT DIFFERENT DOOR TYPES

Opener comes with adaptors for most sheet door drum types as well as an optional Live Axle Kit to suit live axle doors.

### INTELLIGENT SAFETY SYSTEM (ISS)

If contact is made with an obstruction while moving, the opener either stops or reverses the door to reduce the risk of injury or property damage.

### SOFT START / SOFT CLOSE

The Soft Start / Soft Close feature ramps speed up and down at the start and end of each cycle,

# DOMINATOR™ EASYROLLER 14



## TECHNICAL SPECIFICATIONS

<b>Power</b>	Input Voltage	120 Vac / 60Hz
	Standby Power	2.2W
	Motor Type	24V d.c. Permanent Magnet
	Motor Power	100W
<b>Installation<sup>1,2</sup></b>	Door Size (approx.)	180 ft <sup>2</sup>
	Door Height (max) <sup>3</sup>	14 ft
	<b>Transmitter System</b>	Receiver/Transmitter Frequency
	Coding System	TrioCode™ 128, code hopping
	Code Combinations	3.4x10 <sup>38</sup> code combinations
	Transmitter Capacity (x 4-button registers)	64
<b>Additional Features</b>	Courtesy Light	2 x LED
	Safety Beam Compatibility	2-wire Safety Beams
	Drum Wheel Adaptor	Suits most doors*
<b>Warranty<sup>4</sup></b>	5 year/10,000 cycles on parts <sup>4</sup> 1 year on accessories	

\*Suits most rolling sheet doors. Not suitable for rolling steel doors

### OPTIONAL ACCESSORIES



**Wireless Keypad** Weather resistance, secure access without a transmitter or keys is great for school kids and active families.

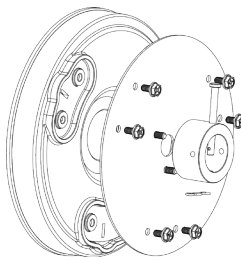

**Live Axle Kit:** Adaptor kit for Live axle sheet doors.

<sup>1</sup> Windy conditions can activate the obstruction feature of the opener.

<sup>2</sup> Suitable for use on dead axle doors.

<sup>3</sup> Max height 14ft on a door with a 12" drum wheel. Less opening height on a door with a 9.5" drum wheel.

<sup>4</sup> Please see full warranty terms and conditions on our website. This brochure is not evidence of our warranty. Our warranty is in addition to any consumer guarantees that may apply under American Law.

### SAFETY & SECURITY FEATURES



Soft Start/Soft Close



Intelligent Safety System



Door Profiling



TrioCode™ 128

### POWER & MOUNTING SYSTEMS



DC Motor

### OPERATING MODES & FEATURES



LED Courtesy Lights



Auto Close



Service Indicator



Vacation Mode



AUX Auxiliary Output

\*See our website for our icon glossary explanations.

Member of:



Automatic Technology America  
3626 North Hall Street, Suite 610, Dallas, TX 75219, United States of America

SMART  
SIMPLE  
SECURE

©2022 Automatic Technology America. All rights reserved. The Automatic Technology logos, "smart simple secure" wordage, feature icons and Dominator™ & EasyRoller™ are trademarks of Automatic Technology Australia Pty Ltd. Except as allowed by law, no part of this brochure may, in any form or by any means, be reproduced, stored in a retrieval system of transmitted without prior written permission. In an ongoing commitment to product quality we reserve the right to change specification without notice. E&OE. Vineyard Centre II, 1452 Hughes Road, Grapevine, Texas 76051, United States of America.

PH: 1-800-934-9892

For more information on this door opener and other Automatic Technology products please visit us online at [www.ata-america.com](http://www.ata-america.com)

automatic  
TECHNOLOGY

POD#\_07332